

**TDI WINDSTORM REQUIREMENTS**

Underlayment Must Meet

- ASTM D226 Type II                      -AC 188
- ASTM D4869 Type III or IV       -AC 207
- ASTM D6757                              -AC 48
- ASTM D1970
- ASTM D8257

Shingles Must Meet

- ASTM D3161 Class F
- ASTM D7158 Class G or H
- \*Installation pattern per manufacturer instructions for high wind areas\*

**APPLICATION OF NAILS**

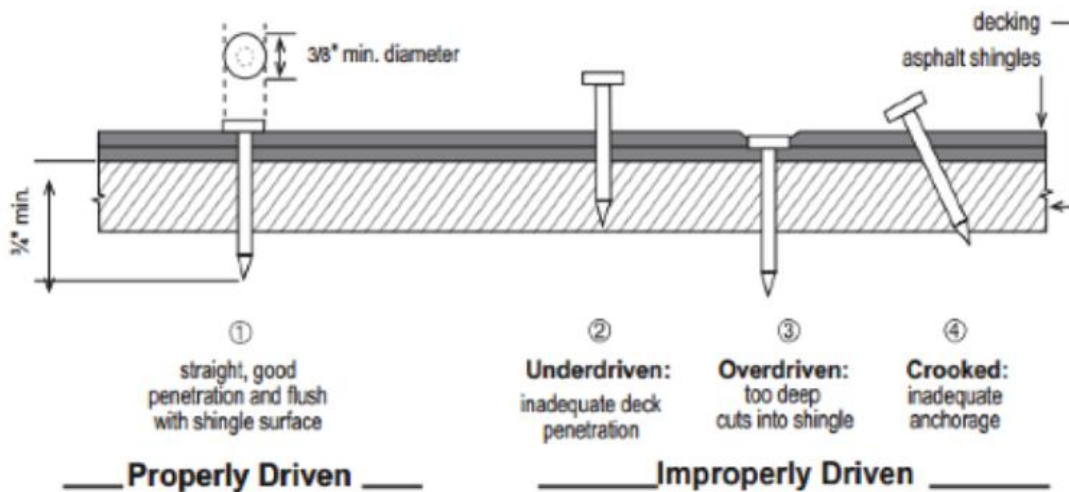

**Effective April 1<sup>st</sup>, 2026**

**Code Requirements for Drip Edge**

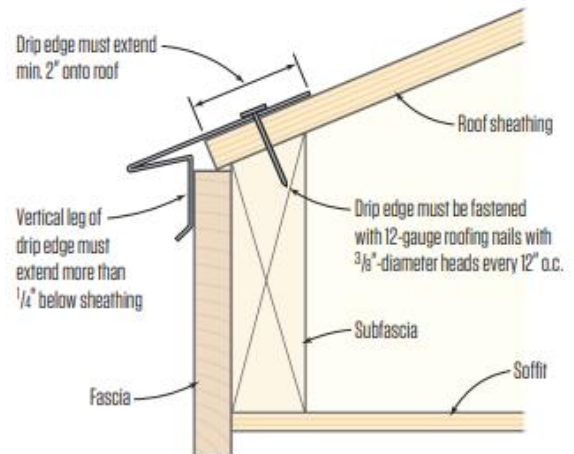

**(R905.1.2) UNDERLAYMENT APPLICATION FOR AREAS WHERE WIND DESIGN IS REQUIRED IN ACCORDANCE WITH FIGURE (R301.2.1.1): UNDERLAYMENT SHALL BE ONE OF THE FOLLOWING METHODS:**  
(See pg. 2 & 3 for diagrams)

1. Double layer of underlayment
2. Decking seems taped/sealed w/single layer of underlayment
3. Modified bitumen underlayment

- DOUBLE LAYER OF UNDERLAYMENT:** Two layers of mechanically fastened underlayment applied in the following manner: Apply a strip of underlayment that is half the width of a full sheet parallel to and starting at the eaves, fastened sufficiently to hold in place. Starting at the eave, apply full-width sheets of underlayment, overlapping successive sheets half of the width of a full sheet plus 2 inches. Distortions in the underlayment shall not interfere with the ability of the shingles to seal. End laps shall be 4 inches and shall be offset by 6 feet.

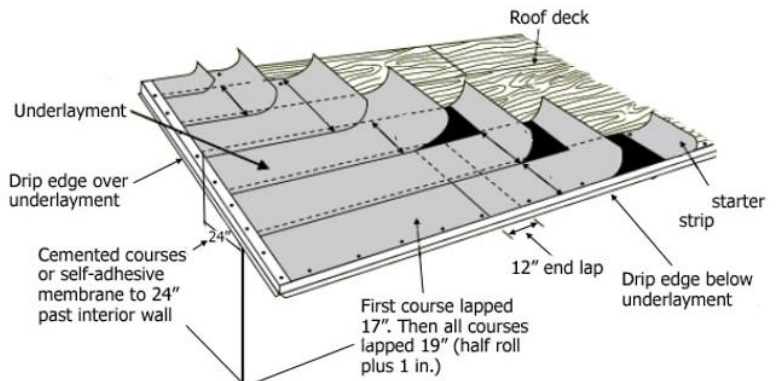
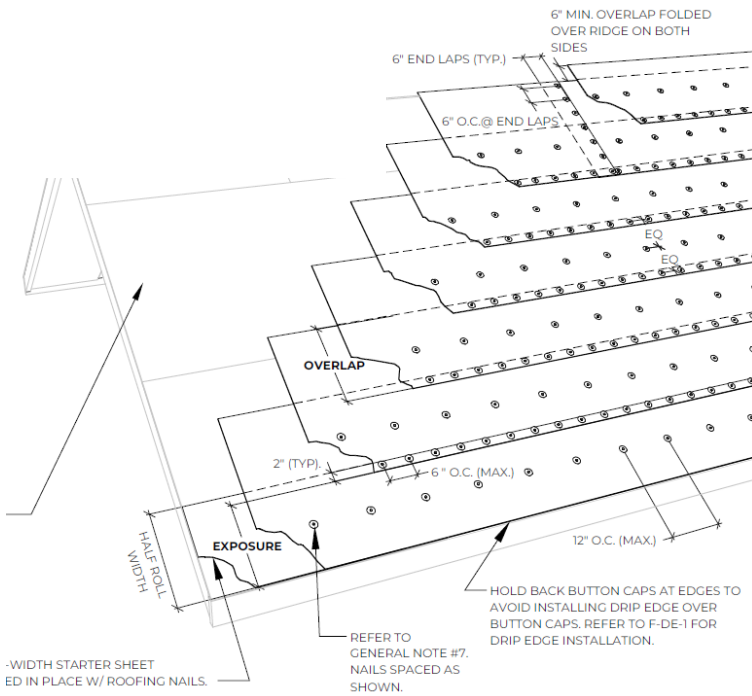

- DECKING SEAMS TAPED:** A minimum 4-inch-wide strip of self-adhering polymer modified bitumen underlayment complying with ASTM D1970, installed in accordance with the manufacturer's installation instructions for the deck material, shall be applied over all joints in the roof decking. An approved underlayment complying with table R905.1.1 (1) for the applicable roof covering shall be applied over the entire roof over the 4-inch-wide membrane strips.

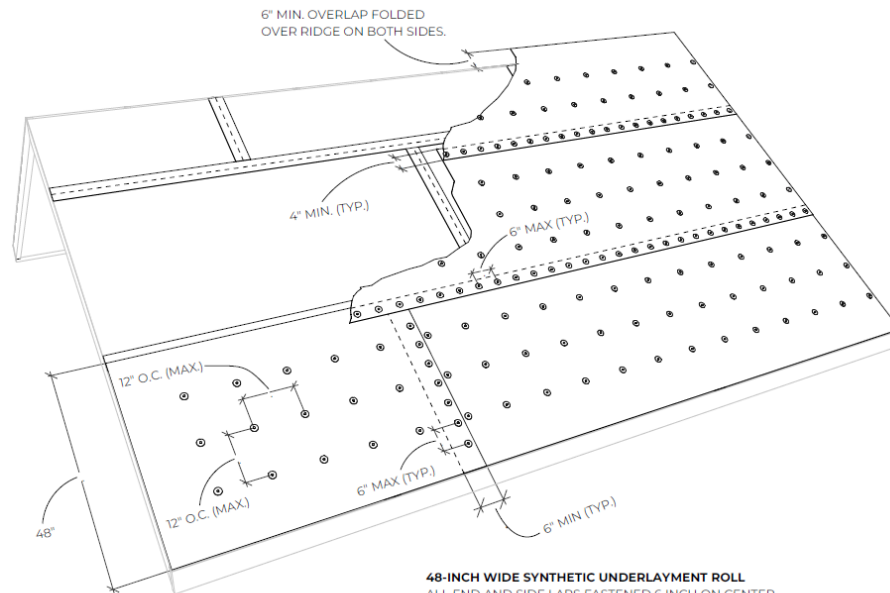

**48-INCH WIDE SYNTHETIC UNDERLAYMENT ROLL**  
ALL END AND SIDE LAPS FASTENED 6 INCH ON CENTER  
THREE (3) ROWS OF NAILS BETWEEN SIDE LAPS 12 INCHES ON CENTER.

3. **FULL MODIFIED BITUMEN UNDERLAYMENT:** A single layer of self-adhering polymer modified bitumen underlayment complying with ASTM D1970, installed in accordance with the underlayment and roof covering manufacturer's installation instructions for the deck material, roof ventilation configuration and climate exposure of the roof covering.

